

Tree condition survey
at
Flood Meadows, Alton
for
Alton Town Council

sapling arboriculture ltd

Ben Abbatt
Dip. Arb. (RFS), BA (Hons), MICFor, MRICS, CEnv
Arboricultural Association Registered Consultant



Holbache Mount Pleasant Road, Alton, Hants,
GU34 2RS

t: 01420 550 160
e: enquiries@saplingarboriculture.com
w: www.saplingarboriculture.com

Reference: J064 / 15
December 2018



Contents

Instruction

Tree condition survey

General notes

Key

Site plan

Instruction

The tree survey is to be carried out in relation to the landowner's duty under the Occupier's Liability Act 1984 and common law. The tree survey will be carried out from ground level, identifying significant tree features that may have significant bearing upon the condition and management of the tree and giving appropriate recommendations and priorities.

Typical significant defects that are to be identified can be referred to in "Hazards from Trees, a general guide" by David Lonsdale and "The body language of trees" by Claus Mattheck published by the Forestry Commission and the Department of the Environment respectively.

Tree Condition Survey Sheet

Site: Flood Meadows, Alton
 Date of survey: 3rd December 2018
 Weather: Clear with light wind.
 Surveyed by: Ben Abbatt

No	Species	Height (m)	Age class	Condition (Physiological and structural)		Recommendations	Priority for works
1	Sycamore	14	Mature	Good	Minor branch inclusions.	Crown lift to 3m all round.	Low
2	Wild Cherry	8	Middle aged	Good	-	Crown lift to 3m all round.	Low
3	Ash	9	Middle aged	Good	-	Crown lift to 3m all round.	Low
4	Beech	7	Middle aged	Good	Yellowing foliage. Rubbing stems.	Crown lift to 3m all round. Maximum wound diameter to be 75mm.	Low
5	Copper Beech	6	Middle aged	Good	-	Crown lift to 3m all round.	Low
6	Small Leaved Lime	6	Middle aged	Good	Minor branch inclusions.	Crown lift to 3m all round.	Low
7	Beech	5	Middle aged	Good	Tight unions leading to weaker branch attachment.	Formative prune. Crown lift to 3m all round.	Low
8	Copper Beech	6	Middle aged	Good	Several crossing / running branches.	Formative prune. Crown lift to 3m all round.	Low
9	Silver Lime	8	Middle aged	Good	-	Crown lift to 3m all round.	Low
10	English Oak	6	Middle aged	Fair	Chlorotic leaves evident. Minor bark damage in crown.	Crown lift to 3m all round.	Low
11	Copper Beech	6	Middle aged	Good	-	Crown lift to 3m all round.	Low
12	Beech	6	Middle aged	Good	-	Crown lift to 3m all round.	Low
13	Ash	7	Middle aged	Good	-	Crown lift to 3m all round.	Low
14	Lime	5	Middle aged	Good	-	Crown lift to 2m all round.	Low

No	Species	Height (m)	Age class	Condition (Physiological and structural)		Recommendations	Priority for works
15	Cherry	5	Middle aged	Fair	Sparse canopy evident. Canker on main stem.	No works required at time of survey.	-
16	Beech	5	Middle aged	Good	-	Crown lift to 3m all round.	Low
17	Lime	4	Middle aged	Good	-	Crown lift to 3m all round.	Low
18	Lime	4	Middle aged	Good	Multiple stems from ground level.	Crown lift to 3m all round.	Low
19	Copper Beech	6	Middle aged	Good	-	Crown lift to 3m all round.	Low
20	Beech	2	Young	Good	-	No works required at time of survey.	-
21	Field Maple	5	Middle aged	Good	-	Crown lift to 2m all round.	Low
22	Beech	4	Middle aged	Good	-	Crown lift to 2m all round.	Low
23	Beech	5	Middle aged	Good	-	Crown lift to 3m all round.	Low
24	Field Maple	6	Middle aged	Good	Recent root plate movement resulting in lean to North - appears to have stabilised.	Crown lift to 3m all round.	Low
25	Copper Beech	5	Middle aged	Good	-	Crown lift to 3m all round.	Low
26	Beech	4	Middle aged	Good	-	Crown lift to 3m all round.	Low
27	Field Maple	5	Middle aged	Good	-	No works required at time of survey.	-
28	Field Maple	6	Middle aged	Good	Exudate at base.	No works required at time of survey.	-
29	Field Maple	5	Middle aged	Good	-	No works required at time of survey.	-
30	Silver Birch	7	Middle aged	Good	-	No works required at time of survey.	-
31	Silver Birch	3	Young	Good	-	No works required at time of survey.	-
32	Silver Birch	6	Middle aged	Good	-	No works required at time of survey.	-
33	Field Maple	6	Mature	Good	-	No works required at time of survey.	-

No	Species	Height (m)	Age class	Condition (Physiological and structural)		Recommendations	Priority for works
				Condition	Structural		
34	Field Maple	7	Mature	Good	-	No works required at time of survey.	-
35	Field Maple	7	Mature	Good	-	No works required at time of survey.	-
36	Field Maple	9	Mature	Good	-	No works required at time of survey.	-
37	Field Maple	8	Middle aged	Fair	Intermediate canopy.	No works required at time of survey.	-
38	Sycamore	7	Middle aged	Good	Majority of canopy to North.	No works required at time of survey.	-
39	Field Maple	6	Mature	Removed	-	Plant replacement tree in next growing season.	Low
40	Field Maple	7	Mature	Fair	Suppressed with majority of canopy to South.	No works required at time of survey.	-
41	Field Maple	7	Mature	Poor	Sparse canopy and deadwood evident. 3 main stems from 1m.	No works required at time of survey.	-
42	Goat Willow	8	Mature	Good	Multiple stems at base. Minor deadwood evident.	Crown lift to 3m all round.	Low
43	Silver Birch	10	Middle aged	Good	-	No works required at time of survey.	-
44	Ash	16	Mature	Good	Dominant canopy. Good vitality shown by twig and leaf size, structure, colour and density. Large deadwood (more than 100mm diameter) over long grassed area – public access not anticipated.	No works required at time of survey.	-
45	Sycamore	16	Mature	Good	-	No works required at time of survey.	-
46	White Willow	18	Mature	Removed	-	-	-
47	Group of Hawthorn	10	Mature	Fair	Recently reduced to 4m with young regrowth. Adjacent to bench.	No works required at time of survey.	-

No	Species	Height (m)	Age class	Condition (Physiological and structural)		Recommendations	Priority for works
48	Common Alder	12	Mature	Good	Multiple stems. Minor deadwood evident. Encroaches over footway.	No works required at time of survey.	-
49	Ash	12	Middle aged	Good	Multiple stems. Ivy and deadwood evident. Encroaches over footway. Recent works have left large rip cut wound.	Crown lift to 4m all round. Remove deadwood more than 25mm diameter. Remove 2 low branches over gravel footway.	Low Low Low
50	Ash	16	Mature	Good	Deadwood evident. Encroaches over footway.	Remove deadwood more than 25mm. Crown lift to 4m all round.	Moderate Low
51	Ash	16	Mature	Good	Multi-stemmed at ground level. Encroaches over footway.	No works required at time of survey.	-
52	Ash	18	Mature	Poor	Ivy previously severed. Deadwood evident. Bark splits and cracks in upper crown with exudates from cracks. Recent crown reduction.	No works required at time of survey.	-
53 (Tag 0921)	Ash	20	Mature	Good	Twin stemmed at base. Recent crown reduction works to less than 16m.	No works required at time of survey.	-
54	Ash	20	Mature	Removed	-	-	-
55	Ash	20	Mature	Removed	-	-	-
56	Ash	16	Mature	Good	Overhangs nearby garage. Historic pruning towards nearby garage.	No works required at time of survey.	-
57	Wild Cherry	16	Mature	Fair	Sparse and chlorotic canopy. Minor deadwood (less than 25mm diameter) evident. Lamp column adjacent.	No works required at time of survey.	-

No	Species	Height (m)	Age class	Condition (Physiological and structural)		Recommendations	Priority for works
58	Common Alder	18	Mature	Good	-	No works required at time of survey.	-
59	Common Alder	18	Mature	Good	Minor deadwood (less than 25mm diameter) evident.	No works required at time of survey.	-
60	Crack Willow	20	Mature	Removed	-	-	-
61	Crack Willow	20	Mature	Removed	-	-	-
62	Crack Willow	20	Mature	Removed	-	-	-
63	Crack Willow	20	Mature	Removed	-	-	-
64	Wild Cherry	12	Mature	Removed	-	-	-
65	Swedish Whitebeam	12	Mature	Good	-	No works required at time of survey.	-
66	Field Maple	16	Mature	Good	-	No works required at time of survey.	-
67	Wild Cherry	14	Mature	Good	Minor deadwood (less than 25mm diameter) evident. Failed stem at 5m over footway.	Remove.	HIGH
68	Field Maple	16	Mature	Good	-	No works required at time of survey.	-
69	Field Maple	16	Mature	Fair	Sparse canopy. Some tight forks evident. Black tarry exudates on lower main stem.	No works required at time of survey.	-
70	Swedish Whitebeam	16	Mature	Good	Moderate (25-100mm diameter) and minor deadwood (less than 25mm diameter) evident. Suppressed inner canopy.	Remove deadwood more than 25mm diameter.	Low
71	Field Maple	14	Mature	Poor	Crown one sided from heavy crown lift.	No works required.	-
72	Field Maple	14	Mature	Good	Moderate deadwood (25-100mm diameter) evident.	Remove deadwood more than 25mm diameter.	Low

No	Species	Height (m)	Age class	Condition (Physiological and structural)		Recommendations	Priority for works
73	Field Maple	14	Mature	Good	Moderate deadwood (25-100mm diameter) evident. Encroaching on footway.	Remove deadwood more than 25mm diameter. Crown lift to 4m over footway.	Low Low
74	Field Maple	16	Mature	Good	-	No works required at time of survey.	-
75	Field Maple	16	Mature	Good	Moderate deadwood (25-100mm diameter) evident. Minor mechanical damage to surface roots.	Remove deadwood more than 25mm diameter.	Low
76	Wild Cherry	16	Mature	Fair	Minor deadwood (less than 25mm diameter) evident. Moderate included bark union.	No works required at time of survey.	-
77	Field Maple	14	Mature	Good	Moderate deadwood (25-100mm diameter) evident.	Remove deadwood more than 25mm diameter.	Low
78	Field Maple	16	Mature	Good	Minor deadwood (less than 25mm diameter) evident. Branch stubs evident.	No works required.	-
79	Silver Maple	18	Mature	Fair	Dark exudate at base – bark necrosis.	No works required at time of survey.	-
80	Wild Cherry	8	Middle aged	Removed	-	-	-
81	Field Maple	12	Mature	Good	-	No works required at time of survey.	-
82	Swedish Whitebeam	8	Mature	Good	Minor deadwood (less than 25mm diameter) evident.	No works required at time of survey.	-
83	Swedish Whitebeam	8	Mature	Good	Minor deadwood (less than 25mm diameter) evident.	No works required at time of survey.	-
84	Field Maple	8	Young	Good	-	No works required at time of survey.	-
85	Wild Cherry	16	Mature	Good	Moderate deadwood (25-100mm diameter) throughout. Surface roots with mechanical damage. Roots disturbing tarmac footway beneath.	Remove deadwood more than 25mm.	Moderate

No	Species	Height (m)	Age class	Condition (Physiological and structural)		Recommendations	Priority for works
86	Wild Cherry	14	Mature	Good	Moderate deadwood (25-100mm diameter) evident. Surface roots with mechanical damage evident.	Remove deadwood more than 25mm.	Moderate
87	Swedish Whitebeam	14	Mature	Good	Moderate deadwood (25-100mm diameter) throughout.	Remove deadwood more than 25mm.	Low
88	Field Maple	16	Mature	Good	Moderate deadwood (25-100mm diameter) evident. Surface roots with mechanical damage.	Remove deadwood more than 25mm.	Low
89	Field Maple	16	Mature	Good	Moderate deadwood (25-100mm diameter) evident.	Remove deadwood more than 25mm.	Low
90	Wild Cherry	14	Middle aged	Good	-	No works required at time of survey.	-
91	Wild Cherry	16	Mature	Fair	Moderate deadwood (25-100mm diameter) throughout. Surface roots with mechanical damage. Bacterial canker evident at c1.8m. Pholiota squarrosa at base.	Remove deadwood more than 25mm.	Moderate
92	Field Maple	5	Young	Poor	Mechanical damage at c2.5m more than 50% of stem girth.	Remove.	Low
93	Field Maple	16	Mature	Good	Minor deadwood evident (less than 25mm diameter).	No works required at time of survey.	-
94	Field Maple	18	Mature	Good	Moderate deadwood (25-100mm diameter) and broken branches evident.	Remove deadwood more than 25mm.	Moderate
95	Wild Cherry	18	Mature	Good	-	No works required at time of survey.	-
96	Wild Cherry	18	Mature	Good	Surface roots and mechanical damage evident due to mowers.	No works required at time of survey.	-
97	Wild Cherry	16	Middle aged	Good	Minor deadwood (less than 25mm diameter) evident.	No works required at time of survey.	-

No	Species	Height (m)	Age class	Condition (Physiological and structural)		Recommendations	Priority for works
98	Aspen	14	Middle aged	Good	Lean over footway.	Crown lift to 4m all round.	Low
99	Whitebeam	5	Middle aged	Good	-	No works required at time of survey.	-
100	Hawthorn	6	Mature	Good	Naturally leans over the informal footway.	Clear lamp by 1.5m.	Low
101	Wild Cherry	14	Middle aged	Good	-	No works required at time of survey.	-
102	Wild Cherry	18	Mature	Good	Minor deadwood (less than 25mm diameter) over parking bays. Heavily crown lifted over car park leaving large wounds. Poor form.	No works required at time of survey.	-
103	Wild Cherry	12	Young	Good	-	No works required at time of survey.	-
104	Field Maple	12	Young	Good	-	No works required at time of survey.	-
105	Field Maple	8	Young	Good	Encroaching on car parking area.	Crown lift to 3m over car parking.	Low
106	Wild Cherry	14	Mature	Removed	-	-	-
107	Swedish Whitebeam	12	Mature	Good	-	No works required at time of survey.	-
108	<i>Sugar Maple</i>	>15	<i>Mature</i>	Removed	-	<i>Remove stump and plant replacement specimen.</i>	<i>Low</i>
109	<i>Sugar Maple</i>	>15	<i>Mature</i>	Fair	<i>Sparse, small and yellowing foliage. Large amount of deadwood with approx. half the crown dead.</i>	<i>Remove stump and plant replacement specimen.</i>	<i>Low</i>
110	<i>Ash</i>	>15	<i>Mature</i>	Good	<i>Intermediate canopy. Good vitality shown by twig and leaf size, structure, colour and density. Typical moderate deadwood (25-100mm diameter).</i>	<i>Crown lift to 4m all round. Remove deadwood more than 25mm diameter.</i>	<i>Low</i>
111	<i>Sugar Maple</i>	>15	<i>Middle aged</i>	Good	<i>Intermediate canopy. Good vitality shown by twig and leaf size, structure, colour and density. Low branches. Epicormic growth at base.</i>	<i>Crown lift to 4m all round. Remove epicormic growth.</i>	<i>Low</i>

No	Species	Height (m)	Age class	Condition (Physiological and structural)		Recommendations	Priority for works
112	Sugar Maple	>15	Middle aged	Good	Intermediate canopy. Good vitality shown by twig and leaf size, structure, colour and density. Typical moderate deadwood (25-100mm diameter). Epicormic growth at base.	Crown lift to 4m all round. Crown lift to 5m over carriageway. Remove deadwood more than 25mm diameter. Remove epicormic growth.	Low Low Low Low
113	Sugar Maple	>15	Middle aged	Good	Intermediate canopy. Good vitality shown by twig and leaf size, structure, colour and density.	Crown lift to 4m all round. Clear lamp by 2m.	Low Low
114	Hawthorn	<10	Mature	Removed	-	-	-
115	Elder	-	-	Removed	-	-	-
116	Hawthorn	<10	Mature	Removed	-	-	-
117	Hawthorn	<10	Mature	Removed	-	-	-
118 (within G1)	Cherry	<10	Mature	Fair	Stem with heavy lean but no evidence of recent root plate movement.	Remove.	Moderate
119 (within G1)	Elder	<10	Mature	Removed	-	-	-
120 (within G3)	Willow	10 - 15	Mature	Removed	-	-	-
121 (within G3)	Dead	<10	Young	Removed	-	-	-
122 (within G2)	Elder	<10	Middle aged	Removed	-	-	-
123 (within G1)	Oak	c16	Mature	Good	-	No works required at time of survey.	-
124 (within G3)	Ash	c16	Mature	Removed	-	-	-

No	Species	Height (m)	Age class	Condition (Physiological and structural)		Recommendations	Priority for works
125	Cherry	7	Middle Aged	Poor	Ivy impedes survey. Asymmetrical canopy towards footway.	Remove.	Moderate
126	Willow	15	Mature	Poor	Failed at base and leaning into adjacent Ash, adjacent to footway.	Remove.	HIGH
127	Willow	15	Mature	Poor	One main and one minor stem with main stem leaning over watercourse towards adjacent property.	Coppice.	Moderate
G1	Ash, Wild Cherry, Dogwood, Elder, Hawthorn, Hazel, Norway Spruce.	15	Mature	Good	Linear group which defines the south western corner of the site. Remnant hedgerow species evident. Spruce trees are not commensurate with typical local species.	Sever ivy at base of trees in South West corner and remove to allow resurvey to be carried out. Advise Arboriculturalist once ivy has been cleared to enable survey to be carried out.	Low Low
G2	Ash, Beech, Wild Cherry, Horse Chestnut, Elder, Field Maple, Hawthorn, Hazel, Lime, English Oak, Yew.	14	Mature	Good	Distinct small copse with footway boundaries to north and south. Generally very good condition, but might warrant a canopy thinning exercise to promote well spaced and structured canopy development. Hazel could be coppiced on a regular cycle (1/5 th).	Remove fallen tree. Create and maintain 4m clearance over footway and 2m back from the footway edge with maximum wound diameter to be 100mm. Coppice Hazel. Sever ivy at base on trees more than 400mm diameter at 1.5m height.	Moderate Low Low Low
G3	Ash, Elder, Horse Chestnut, Hawthorn, Goat Willow, Elm, Sycamore, Oak.	6-16	Mature	Good	Linear group running up to the entrance to the Osier beds and the timber steps and bridges. Recent felling and clearance work carried out (2015). Vegetation impedes survey and access. Series of leaning and fallen trees towards the water beds.	Crown lift to 4m over footway and 2m back from the footway edge. Maintain long grass and dead hedging to diminish public access into the group.	Low Low

No	Species	Height (m)	Age class	Condition (Physiological and structural)	Recommendations	Priority for works
G4	Ash, Elder, Horse Chestnut, Hazel, Goat Willow, Sycamore.	16	Mature	Good Linear group that follows the northern boundaries of the remnant Osier beds, and runs down to the Tanhouse Lane entrance. In places the group is only a metre or so wide, with the footway immediately adjacent. Series of ivy laden trees with several fallen over towards Osier beds.	Crown lift to 4m over the footway and 25m back from the footway edge. Clear base of trees more than 300mm diameter at 1.5m height and inform Arboriculturalist once clear to allow survey to be carried out.	Low Moderate
G5	Group of 3 distinct Osier stands.	6	Mature	Good Three distinct remnant groups. Possibility of re coppicing these trees to promote and conserve the stands. Clearance, crown lifting, and coppicing work recently carried out (2015). Significant amount of Ivy growing on stems.	Crown lift to 4m over the footway and 2m back from the footway edge. Cut ivy at base.	Low Low
G6	Beech, Copper Beech, Wild Cherry, Horse Chestnut, Hazel, Yew.	10	Mature	Good Distinct small copse with footway boundaries to north and southwest. Generally good condition, but canopy thinning to promote well spaced and structured canopy development. Hazel to be coppiced on a regular 15 year cycle. Squirrel damage throughout. Basal root damage Leaning trees towards footway and open space. Series of dead trees. Trees with moderate included bark unions. Broken branches in several trees.	Remove dead trees. Remove leaning trees towards open space. Crown lift to 4m over the footway and 2m back from the footway edge. Sever ivy at base. Clear lamps by 2m. Forestry thin by 20% to retain trees of good form and structure.	Moderate Moderate Low Low Low

No	Species	Height (m)	Age class	Condition (Physiological and structural)	Recommendations	Priority for works
G7	Ash, Beech, Copper Beech, Silver Birch, Elder, Field Maple, Hawthorn, Hazel, Lime, English Oak, Wayfaring Tree.	10	Mature	Good Distinct small copse with footway boundary to south. Well-used informal track around the north of the copse. Generally very good condition, but might warrant a canopy thinning exercise to promote well spaced and structured canopy development. Hazel could be coppiced on a regular 15 year cycle. Typical squirrel damage on thin bark tree species.	Crown lift to 4m over the footway and 2m back from the footway edge. Forestry thin by 20% to retain trees of good form and structure.	Low Low
G8	Dogwood, Hawthorn, Hazel, Holly, Lime, Whitebeam	6	Mature	Good Linear group running along the eastern boundary of the site. Private gardens to the east and footway to the west. Dogwood starting to encroach over footway.	Crown lift to 4m over the footway and 2m back from the footway edge. Dogwood and Hazel to be coppiced on an annual cycle to re-introduce a graded western edge to the group.	Low Low
G9	Aspen, Dogwood, Hawthorn, Hazel, Goat Willow, Alder	15	Mature	Good Linear group running along the eastern boundary of the site. Private gardens to the east and footway to the west. Dogwood starting to encroach over footway.	Crown lift to 4m over the footway and 2m back from the footway edge. Dogwood and Hazel to be coppiced on an annual cycle to re-introduce a graded western edge to the group.	Low Low
G10	Hazel, Whitebeam, Buckthorn, Maple	-	Mature	Good Encroaching on footway.	Clear footway by 3m. Crown lift to 3m over footway.	Low Low

Trees or groups recorded in italics were last surveyed in 2016 and were omitted from the survey at the request of Alton Town Council.

Resurvey to be complete by July 2020.

Varying the time of year for the survey is appropriate to see the structure, vitality and any pests or diseases affecting the trees.

General notes:

The tree survey has been carried out in relation to the landowner's duty under the Occupier's Liability Act 1984 and common law. The tree survey was carried out from ground level, identifying significant tree features that may have significant bearing upon the condition and management of the tree and giving appropriate recommendations and priorities. All dimensions are estimated. No soil investigations will be carried out.

To carry out the tree survey reasonable access around the base of the tree is required. Where this is not feasible, these parts of the tree may not be able to be inspected. If view of the entire structure of the tree(s) is limited, for instance by the properties in private ownership, this is a limitation to the tree survey and some parts of the tree may not be able to be fully surveyed. The tree survey will be carried out from the ground with the aid of binoculars if necessary. The tree will not be climbed as part of this survey.

Typical significant defects that are to be identified can be referred to in "Hazards from Trees, a general guide" by David Lonsdale and "The body language of trees" by Claus Mattheck published by the Forestry Commission and the Department of the Environment respectively.

The tree survey can only be an assessment of the tree at the time of the survey and the tree(s) should be re-surveyed on a regular basis. An appropriate time period between surveys may be up to 5 years depending upon the condition of the trees, their maturity and the target(s). Recommendations for the period between surveys will be given.

As trees are dynamic structures their condition and health may change in a short period of time, particularly in relation to changes in their immediate environment and circumstances. Therefore, the survey is an assessment of the trees at the time of the survey only. If there is a significant change in the immediate environment and circumstances then this should be brought to the attention of the Arboriculturalist so that they may advise accordingly.

I have not checked whether the site is within a Conservation Area or whether the trees are under Tree Preservation Order (TPO). Prior to any tree works confirmation of whether these legal restrictions apply to the site or trees ought to be sought from the Local Planning Authority (LPA). If the trees stand within a Conservation Area designated under the Town and Country Planning Act the LPA will normally require 6 weeks notice of intention to carry out any tree works as detailed in the survey. If the trees are under TPO then the LPA will normally require an application for any tree works. Some tree works are exempt, for instance if the trees are dead or dangerous, and certain works can be carried out without application. It is necessary to give the LPA at least five days notice prior to carrying out any of these tree works under these exemptions. This survey, with recommendations, can be used to support any such application or notice.

Wildlife issues are of significant concern to the general public. A balance has to be found between the protection of wildlife and the need for safety when managing trees. The Wildlife and Countryside Act (1980) and Countryside Rights of Way Act (2000) give statutory protection to wild birds, bats, mammals, some invertebrates and plants. It is important to ensure that this legislation is properly considered when carrying out any works to trees.

Bird nests were not identified whilst on site. However, any Arborist carrying out the tree works should ensure that there is no disturbance to nesting birds prior to the works being carried out. Further guidance upon the appropriate timing of the works can be sought from DEFRA, if necessary. Where nesting birds are found further information should be sought from DEFRA 08459 33 55 77 or helpline@defra.gsi.gov.uk. Prior to any works being implemented the tree contractor must identify whether there are any bats or birds using the tree as roost or nest. If such habitation is identified then the tree contractor must obtain the necessary licence from Natural England (0845 601 4523 www.naturalengland.org.uk) to carry out the works.

In this instance, considering the size of the trees, their location and features I believe that there is a low to medium potential of bats using the mature trees as a roost site. A bat survey prior to tree works is not recommended as it would be difficult to determine the location of any exit point from the roost within the tree by a bat survey and also confusion may also arise from bats travelling from other roosts. Any such exit could more easily be identified by a competent tree worker. During the tree works the contractor should carry out the tree works with bats as an active consideration and follow the current industry best practice, e.g. Arboricultural Association Guidance Note 1 Bats in the context of tree work operations 2011, which a competent tree contractor should be familiar with.

Biosecurity measures: To minimise the potential for contamination of the tree from other tree works it is appropriate to sterilise tools to be used before and after the works are implemented. Appropriate disinfectant includes Propellar or Cleankill Sanitizing spray. Loose debris is to be brushed off prior to treating with disinfectant to ensure appropriate application. See [http://www.forestry.gov.uk/pdf/FCMS028-guidance.pdf/\\$file/FCMS028-guidance.pdf](http://www.forestry.gov.uk/pdf/FCMS028-guidance.pdf/$file/FCMS028-guidance.pdf) for further information on Biosecurity and <http://www.forestry.gov.uk/forestry/infd-9fjd2d> for disinfectant information.

Key to condition survey sheet

No	Tree number.
Species	Species of tree.
Height	Height measured in metres.
Branch Spread	Branch spread in metres taken at the four cardinal points to derive an accurate representation of the crown.
Height of crown	Height in metres of crown clearance above adjacent ground level.
Age Class (Age)	<p>Young A tree considered to be less than approximately 20 years old.</p> <p>Middle aged A tree in approximately the first 1/5th of its normal life span with apical dominance (rapidly growing with a clear main leader) and not yet fully at its environmental potential full height.</p> <p>Mature A tree in its 2/5ths to 5/5ths of its normal life span with apical dominance lost and at its environmental potential full height.</p> <p>Veteran A tree of interest biologically, aesthetically or culturally because of its age and is old relative to others of the same species.</p>
Condition (Physiological and Structural)	<p>Good A tree of typical physiological and structural condition that requires only general tree works to facilitate its retention in the landscape.</p> <p>Fair A tree of impaired physiological and / or structural condition that may require remedial and general tree works to facilitate its retention in the landscape.</p> <p>Poor A tree of significantly impaired physiological and / or structural condition that will require remedial and general tree works to facilitate its retention in the landscape if feasible.</p>
Recommendations	As per BS3998: 2010 Recommendations for Tree Works.
Priority	<p>Immediate Works should be carried out immediately as the probability of harm or damage occurring is likely.</p> <p>High These works are important to carry out as soon as reasonably possible and any budget available for tree management should be spent upon these trees before the moderate and low categories. Works in this category usually will relate to abatement of risk for harm and or damage to occur. Ideally works in this category are anticipated to be carried out within 1 month.</p> <p>Moderate These works are important to carry out as soon as reasonably possible and any budget available for tree management should be spent upon these trees before the low categories. Works in this category usually will relate to abatement of risk for harm and or damage to occur and for the good arboricultural management of the trees. Ideally works in this category are anticipated to be carried out within 3 months.</p> <p>Low Works in this category usually will relate to the good arboricultural management of the trees. Ideally works in this category are anticipated to be carried out within 12 months.</p>
Re-survey	This is the time period in which it is recommended that the tree is surveyed again. This is based upon the condition of the tree, its location, previous, current and future management. It is normally expressed at a time period from the date of the report / survey, which ever is the sooner. If no time period is noted then the default period is one year.

Site plan

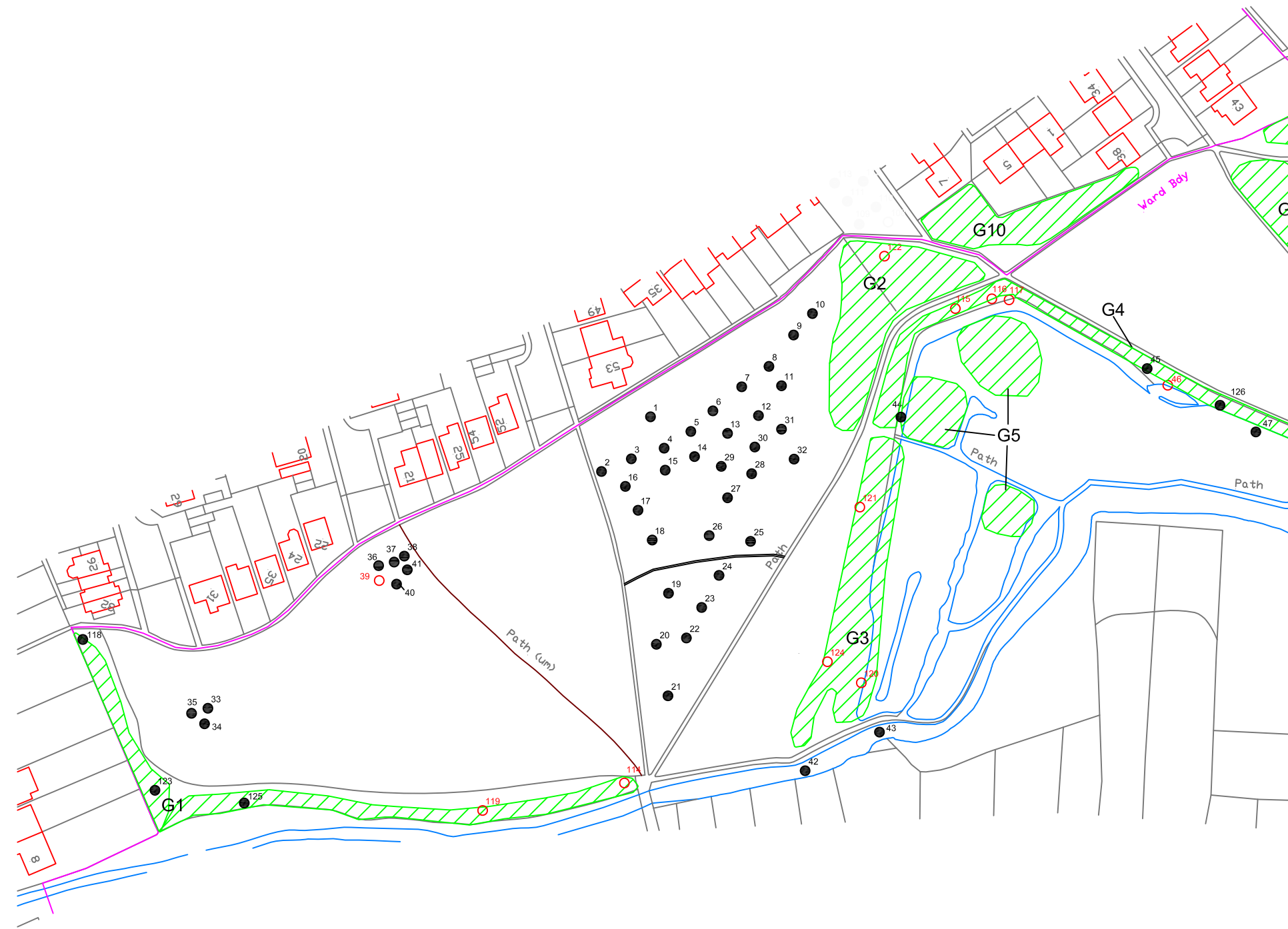

General / Key:

- Tree position ●
- Tree position (removed) ○
- Group position



Client:
Alton Town Council

Site:
Flood Meadows, Alton

Data:
provided under license 100019980.
Crown copyright. All rights reserved.

This drawing is copyright of Sapling Arboriculture Limited and may not be copied, altered or reproduced in any way without written authority from Sapling Arboriculture Limited.

Drawing title:
Tree condition survey

Drawing reference:
J064 / 15

Revision: -

Date:
December 2018

Scale:
N/A on A4 - do not scale

Sheet:
1 of 2

sapling

arboriculture ltd

registered in england: 5414235

T: 01420 544 860
E: ben@saplingarboriculture.com
W: www.saplingarboriculture.com

Ben Abbatt
MICFor, MRICS, CEnv, Dip. Arb. (RFS), BA (Hons)
Arboricultural Association Registered Consultant

Note: tree positions are indicative only due to the access to the trees being limited.

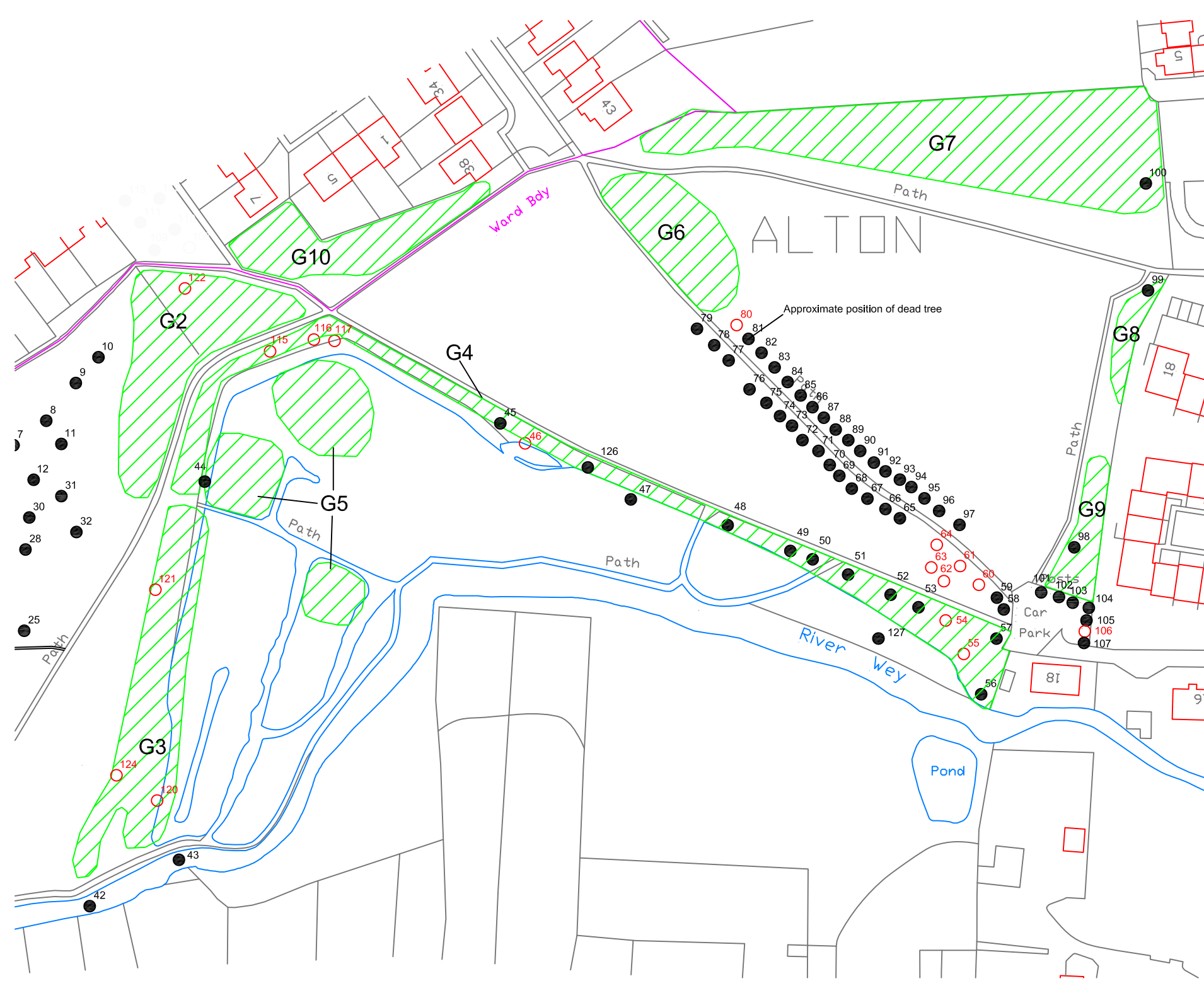

General / Key:

- Tree position ●
- Tree position (removed) ○
- Group position

Client:
Alton Town Council

Site:
Flood Meadows, Alton

Data:
provided under license 100019980.
Crown copyright. All rights reserved.

This drawing is copyright of Sapling Arboriculture Limited and may not be copied, altered or reproduced in any way without written authority from Sapling Arboriculture Limited.

Drawing title:
Tree condition survey

Drawing reference:
J064 / 15

Revision: -

Date:
December 2018

Scale:
N/A on A4 - do not scale

Sheet:
2 of 2

sapling
arboriculture ltd
registered in england: 5414238

T: 01420 544 860
E: ben@saplingarboriculture.com
W: www.saplingarboriculture.com

Ben Abbatt
MCIFor, MRICS, C.Env. Dip. Arb. (RFS), BA (Hons)
Arboricultural Association Registered Consultant

Note: tree positions are indicative only due to the access to the trees being limited.



© 2018