

# Tree condition survey

at

## Flood Meadows, Alton

for

## Alton Town Council

### sapling arboriculture ltd

Ben Abbatt  
Dip. Arb. (RFS), BA (Hons), MICFor, MRICS, CEnv  
Arboricultural Association Registered Consultant



Holbache Mount Pleasant Road, Alton, Hants,  
GU34 2RS

t: 01420 550 160  
e: [enquiries@saplingarboriculture.com](mailto:enquiries@saplingarboriculture.com)  
w: [www.saplingarboriculture.com](http://www.saplingarboriculture.com)

Reference: J064 / 14 / 2016  
November 2016



## **Contents**

Title Page

Contents

Tree condition survey

General notes

Key

Site plan

## Tree Condition Survey Sheet

Site: Flood Meadows, Alton

Date: September 2016

Weather: Clear with light wind.

Surveyed by: Ben Abbatt

No	Species	Height (m)	Age class	Condition (Physiological and structural)		Recommendations	Priority for works
1	Sycamore	14	Mature	<b>Good</b>	Minor branch inclusions.	Crown lift to 3m all round.	Low
2	Wild Cherry	8	Middle aged	<b>Good</b>	-	Crown lift to 3m all round.	Low
3	Ash	9	Middle aged	<b>Good</b>	-	Crown lift to 3m all round.	Low
4	Beech	7	Middle aged	<b>Good</b>	Yellowing foliage. Rubbing stems.	Crown lift to 3m all round. Maximum wound diameter to be 75mm.	Low
5	Copper Beech	6	Middle aged	<b>Good</b>	-	Crown lift to 3m all round.	Low
6	Small Leaved Lime	6	Middle aged	<b>Good</b>	Minor branch inclusions.	Crown lift to 3m all round.	Low
7	Beech	5	Middle aged	<b>Good</b>	Tight unions leading to weaker branch attachment.	Formative prune. Crown lift to 3m all round.	Low
8	Copper Beech	6	Middle aged	<b>Good</b>	Several crossing / running branches.	Formative prune. Crown lift to 3m all round.	Low
9	Silver Lime	8	Middle aged	<b>Good</b>	-	Crown lift to 3m all round.	Low
10	English Oak	6	Middle aged	<b>Fair</b>	Chlorotic leaves evident. Minor bark damage in crown.	Crown lift to 3m all round.	Low

No	Species	Height (m)	Age class	Condition (Physiological and structural)		Recommendations	Priority for works
				Condition	Structural		
11	Copper Beech	6	Middle aged	Good	-	Crown lift to 3m all round.	Low
12	Beech	6	Middle aged	Good	-	Crown lift to 3m all round.	Low
13	Ash	7	Middle aged	Good	-	Crown lift to 3m all round.	Low
14	Lime	5	Middle aged	Good	-	Crown lift to 2m all round.	Low
15	Cherry	5	Middle aged	Fair	Sparse canopy evident.	No works required.	-
16	Beech	5	Middle aged	Good	-	Crown lift to 2m all round.	Low
17	Lime	4	Middle aged	Good	-	Crown lift to 2m all round.	Low
18	Lime	4	Middle aged	Good	Multiple stems from ground level.	Crown lift to 2m all round.	Low
19	Copper Beech	6	Middle aged	Good	-	Crown lift to 3m all round.	Low
20	Beech	2	Young	Good	-	No works required.	-
21	Field Maple	5	Middle aged	Good	-	Crown lift to 2m all round.	Low
22	Beech	4	Middle aged	Good	-	Crown lift to 2m all round.	Low
23	Beech	5	Middle aged	Good	-	Crown lift to 3m all round.	Low

No	Species	Height (m)	Age class	Condition (Physiological and structural)		Recommendations	Priority for works
				Good			
24	Field Maple	6	Middle aged	Good	Recent root plate movement resulting in lean to North - appears to have stabilised.	Crown lift to 3m all round.	Low
25	Copper Beech	5	Middle aged	Good	Slightly sparse canopy evident.	Crown lift to 3m all round.	Low
26	Beech	4	Middle aged	Good	-	Crown lift to 2m all round.	Low
27	Field Maple	5	Middle aged	Good	-	No works required.	-
28	Field Maple	6	Middle aged	Good	-	No works required.	-
29	Field Maple	5	Middle aged	Good	-	No works required.	-
30	Silver Birch	7	Middle aged	Good	-	No works required.	-
31	Silver Birch	3	Young	Good	-	No works required.	-
32	Silver Birch	6	Middle aged	Good	-	No works required.	-
33	Field Maple	6	Mature	Good	-	Crown lift to 3m all round.	Low
34	Field Maple	7	Mature	Good	-	Crown lift to 3m all round.	Low
35	Field Maple	7	Mature	Good	-	Crown lift to 3m all round.	Low
36	Field Maple	9	Mature	Good	-	Crown lift to 3m all round.	Low

No	Species	Height (m)	Age class	Condition (Physiological and structural)		Recommendations	Priority for works
				Condition	Structural		
37	Field Maple	8	Middle aged	Fair	-	Crown lift to 3m all round.	Low
38	Sycamore	7	Middle aged	Good	-	Crown lift to 3m all round.	Low
39	Field Maple	6	Mature	Removed	-	-	-
40	Field Maple	7	Mature	Good	-	Crown lift to 3m all round.	Low
41	Field Maple	7	Mature	Poor	Sparse canopy and deadwood evident.	Crown lift to 3m all round.	Low
42	Goat Willow	8	Mature	Good	Multiple stems at base. Minor deadwood evident.	Crown lift to 3m all round.	Low
43	Silver Birch	10	Middle aged	Fair	Sparse canopy, deadwood and branch stubs evident.	No works required.	-
44	Ash	16	Mature	Good	Dominant canopy. Good vitality shown by twig and leaf size, structure, colour and density. Survey impeded by vegetation.	Clear base by 2m and inform Arboriculturalist to allow survey re-survey to take place.	Moderate
45	Sycamore	16	Mature	Good	Survey impeded by vegetation.	Crown lift to 4m over footway.  Clear base by 2m and inform Arboriculturalist to allow survey re-survey to take place.	Low  Moderate
46	White Willow	18	Mature	Removed	-	-	-
47	Group of Hawthorn	10	Mature	Poor	Recently reduced to 4m with young regrowth.	No works required.	-

No	Species	Height (m)	Age class	Condition (Physiological and structural)		Recommendations	Priority for works
48	Common Alder	12	Mature	<b>Good</b>	Multiple stems. Minor deadwood evident. Encroaches over footway.	Crown lift to 4m all round.	Low
49	Ash	12	Middle aged	<b>Good</b>	Multiple stems. Ivy and deadwood evident. Encroaches over footway. Recent works have left large rip cut wound.	Crown lift to 4m all round.	Low
50	Ash	16	Mature	<b>Good</b>	Deadwood evident. Encroaches over footway.	Remove deadwood more than 25mm.  Crown lift to 4m all round.	Moderate  Low
51	Ash	16	Mature	<b>Good</b>	Multi-stemmed at ground level. Encroaches over footway.	No works required.	-
52	Ash	18	Mature	<b>Poor</b>	Ivy previously severed. Deadwood evident. Bark splits and cracks in upper crown with exudates from cracks.	Crown reduction to final height of 10m with 4m radial canopy spread.	HIGH
53 (Tag 0921)	Ash	20	Mature	<b>Good</b>	Twin stemmed at base. Recent crown reduction works to less than 16m.	No works required.	-
54	Ash	20	Mature	<b>Removed</b>	-	-	-
55	Ash	20	Mature	<b>Removed</b>	-	-	Low

No	Species	Height (m)	Age class	Condition (Physiological and structural)		Recommendations	Priority for works
56	Ash	16	Mature	<b>Good</b>	Multi-stemmed at base. Overhangs nearby garage. Historic pruning towards nearby garage.	No works required.	-
57	Wild Cherry	16	Mature	<b>Fair</b>	Sparse and chlorotic canopy. Deadwood evident. Lamp column adjacent.	No works required.	-
58	Common Alder	18	Mature	<b>Good</b>	-	No works required.	-
59	Common Alder	18	Mature	<b>Good</b>	Minor deadwood (less than 25mm diameter) evident.	No works required.	-
60	Crack Willow	20	Mature	<b>Removed</b>	Stump with Ganoderma species.	Remove stump.	Low
61	Crack Willow	20	Mature	<b>Removed</b>	-	-	-
62	Crack Willow	20	Mature	<b>Removed</b>	-	-	-
63	Crack Willow	20	Mature	<b>Removed</b>	-	-	-
64	Wild Cherry	12	Mature	<b>Removed</b>	-	-	-
65	Swedish Whitebeam	12	Mature	<b>Good</b>	-	No works required.	-
66	Field Maple	16	Mature	<b>Good</b>	-	No works required.	-
67	Wild Cherry	14	Mature	<b>Good</b>	Minor deadwood (less than 25mm diameter) evident.	No works required.	-
68	Field Maple	16	Mature	<b>Good</b>	-	No works required.	-



No	Species	Height (m)	Age class	Condition (Physiological and structural)		Recommendations	Priority for works
69	Field Maple	16	Mature	<b>Fair</b>	Sparse canopy. Some tight forks evident. Black tarry exudates on lower main stem.	No works required.	-
70	Swedish Whitebeam	16	Mature	<b>Good</b>	Moderate (25-100mm diameter) and minor deadwood (less than 25mm diameter) evident. Suppressed inner canopy.	Remove deadwood more than 25mm diameter.	Low
71	Field Maple	14	Mature	<b>Poor</b>	Crown one sided from heavy crown lift.	No works required.	-
72	Field Maple	14	Mature	<b>Good</b>	Moderate deadwood (25-100mm diameter) evident.	Remove deadwood more than 25mm diameter.	Low
73	Field Maple	14	Mature	<b>Good</b>	Moderate deadwood (25-100mm diameter) evident.	Remove deadwood more than 25mm diameter.	Low
74	Field Maple	16	Mature	<b>Good</b>	-	No works required.	-
75	Field Maple	16	Mature	<b>Good</b>	Moderate deadwood (25-100mm diameter) evident. Minor mechanical damage to surface roots.	Remove deadwood more than 25mm diameter.	Low
76	Wild Cherry	16	Mature	<b>Good</b>	Minor deadwood (less than 25mm diameter) evident. Some tight forks evident.	No works required.	-
77	Field Maple	14	Mature	<b>Good</b>	Moderate deadwood (25-100mm diameter) evident.	Remove deadwood more than 25mm diameter.	Low
78	Field Maple	16	Mature	<b>Good</b>	Minor deadwood (less than 25mm diameter) evident. Branch stubs evident.	No works required.	-

No	Species	Height (m)	Age class	Condition (Physiological and structural)		Recommendations	Priority for works
79	Silver Maple	18	Mature	<b>Good</b>	-	Crown lift to 4m over footway	Low
80	Wild Cherry	8	Middle aged	<b>Removed</b>	-	-	-
81	Field Maple	12	Mature	<b>Good</b>	-	No works required.	-
82	Swedish Whitebeam	8	Mature	<b>Good</b>	Minor deadwood (less than 25mm diameter) evident.	No works required.	-
83	Swedish Whitebeam	8	Mature	<b>Good</b>	Minor deadwood (less than 25mm diameter) evident.	No works required.	-
84	Field Maple	8	Middle aged	<b>Good</b>	-	No works required.	-
85	Wild Cherry	16	Mature	<b>Good</b>	Moderate deadwood (25-100mm diameter) throughout. Surface roots with mechanical damage. Roots disturbing tarmac footway beneath.	Remove deadwood more than 25mm.	Moderate
86	Wild Cherry	14	Mature	<b>Good</b>	Moderate deadwood (25-100mm diameter) evident. Surface roots with mechanical damage evident.	Remove deadwood more than 25mm.	Moderate
87	Swedish Whitebeam	14	Mature	<b>Good</b>	Moderate deadwood (25-100mm diameter) throughout.	Remove deadwood more than 25mm.	Low
88	Field Maple	16	Mature	<b>Good</b>	Moderate deadwood (25-100mm diameter) evident. Surface roots with mechanical damage.	Remove deadwood more than 25mm.	Low

No	Species	Height (m)	Age class	Condition (Physiological and structural)		Recommendations	Priority for works
89	Field Maple	16	Mature	<b>Good</b>	Moderate deadwood (25-100mm diameter) evident.	Remove deadwood more than 25mm.	Low
90	Wild Cherry	14	Middle aged	<b>Good</b>	-	No works required.	-
91	Wild Cherry	16	Mature	<b>Fair</b>	Moderate deadwood (25-100mm diameter) throughout. Surface roots with mechanical damage. Bacterial canker evident. Sparse canopy.	Remove deadwood more than 25mm.	Moderate
92	Field Maple	5	Young	<b>Good</b>	-	No works required.	-
93	Field Maple	16	Mature	<b>Good</b>	Minor deadwood evident (less than 25mm diameter).	No works required.	-
94	Field Maple	18	Mature	<b>Good</b>	Moderate deadwood (25-100mm diameter) and broken branches evident.	Remove deadwood more than 25mm.	Moderate
95	Wild Cherry	18	Mature	<b>Good</b>	Minor deadwood (less than 25mm diameter) evident.	No works required.	-
96	Wild Cherry	18	Mature	<b>Good</b>	Surface roots and mechanical damage evident.	No works required.	-
97	Wild Cherry	16	Middle aged	<b>Good</b>	Minor deadwood (less than 25mm diameter) evident.	No works required.	-
98	Aspen	14	Middle aged	<b>Good</b>	-	Crown lift to 4m all round.	Low

No	Species	Height (m)	Age class	Condition (Physiological and structural)		Recommendations	Priority for works
99	Whitebeam	5	Middle aged	<b>Good</b>	-	No works required.	-
100	Hawthorn	6	Mature	<b>Good</b>	Naturally leans over the informal footway.	No works required.	-
101	Wild Cherry	14	Middle aged	<b>Good</b>	Minor deadwood (less than 25mm diameter) evident. Narrow union at c2m.	No works required.	-
102	Wild Cherry	18	Mature	<b>Good</b>	Minor deadwood (less than 25mm diameter) over parking bays. Heavily crown lifted over car park leaving large wounds.	No works required.	-
103	Wild Cherry	12	Middle aged	<b>Good</b>	-	No works required.	-
104	Field Maple	12	Mature	<b>Good</b>	-	No works required.	-
105	Field Maple	8	Middle aged	<b>Good</b>	-	No works required.	-
106	Wild Cherry	14	Mature	<b>Removed</b>	-	-	-
107	Swedish Whitebeam	12	Mature	<b>Good</b>	Low branches over public highway and car park.	Crown lift to 4m all round.	Low
108	Sugar Maple	>15	Mature	<b>Removed</b>	-	Remove stump and plant replacement specimen.	Low
109	Sugar Maple	>15	Mature	<b>Fair</b>	Sparse, small and yellowing foliage. Large amount of deadwood with approx. half the crown dead.	Remove stump and plant replacement specimen.	Low

No	Species	Height (m)	Age class	Condition (Physiological and structural)		Recommendations	Priority for works
110	Ash	>15	Mature	<b>Good</b>	Intermediate canopy. Good vitality shown by twig and leaf size, structure, colour and density. Typical moderate deadwood (25-100mm diameter).	Crown lift to 4m all round.  Remove deadwood more than 25mm diameter.	Low  Low
111	Sugar Maple	>15	Middle aged	<b>Good</b>	Intermediate canopy. Good vitality shown by twig and leaf size, structure, colour and density. Low branches. Epicormic growth at base.	Crown lift to 4m all round.  Remove epicormic growth.	Low  Low
112	Sugar Maple	>15	Middle aged	<b>Good</b>	Intermediate canopy. Good vitality shown by twig and leaf size, structure, colour and density. Typical moderate deadwood (25-100mm diameter). Epicormic growth at base.	Crown lift to 4m all round.  Crown lift to 5m over carriageway.  Remove deadwood more than 25mm diameter.  Remove epicormic growth.	Low  Low  Low
113	Sugar Maple	>15	Middle aged	<b>Good</b>	Intermediate canopy. Good vitality shown by twig and leaf size, structure, colour and density.	Crown lift to 4m all round.  Clear lamp by 2m.	Low  Low
114	Hawthorn	<10	Mature	<b>Removed</b>	-	-	-
115	Elder	-	-	<b>Removed</b>	-	-	-
116	Hawthorn	<10	Mature	<b>Removed</b>	-	-	-
117	Hawthorn	<10	Mature	<b>Removed</b>	-	-	-

No	Species	Height (m)	Age class	Condition (Physiological and structural)		Recommendations	Priority for works
118 (within G1)	Cherry	<10	Mature	<b>Fair</b>	Stem with heavy lean but no evidence of recent root plate movement.	Remove.	Low
119 (within G1)	Elder	<10	Mature	<b>Removed</b>	-	-	-
120 (within G3)	Willow	10 - 15	Mature	<b>Removed</b>	-	-	-
121 (within G3)	Dead	<10	Young	<b>Removed</b>	-	-	-
122 (within G2)	Elder	<10	Middle aged	<b>Removed</b>	-	-	-
123 (within G1)	Oak	c16	Mature	<b>Good</b>	Hanging branch c50mm diameter adjacent to footway.	Remove hanging branch.	Low
124 (within G3)	Ash	c16	Mature	<b>Poor</b>	Loss of adjacent companion shelter.	Remove.	Moderate
G1	Ash, Wild Cherry, Dogwood, Elder, Hawthorn, Hazel, Norway Spruce.	10	Mature	<b>Good</b>	Linear group which defines the south western corner of the site. Remnant hedgerow species evident. Spruce trees are not commensurate with typical local species.	No works required.	-

No	Species	Height (m)	Age class	Condition (Physiological and structural)	Recommendations	Priority for works
G2	Ash, Beech, Wild Cherry, Horse Chestnut, Elder, Field Maple, Hawthorn, Hazel, Lime, English Oak, Yew.	14	Mature	<b>Good</b> Distinct small copse with footway boundaries to north and south. Generally very good condition, but might warrant a canopy thinning exercise to promote well spaced and structured canopy development. Hazel could be coppiced on a regular cycle (1/5 <sup>th</sup> ).	Crown lift to 4m over footway and 2m back from the footway edge with maximum wound diameter to be 100mm.  Remove trees with lean more than 30° from vertical; towards footways.  Remove deadwood more than 25mm diameter over footway and grassed areas.  Sever ivy at base on trees more than 400mm diameter at 1.5m height.	Low  Moderate  Low  Low
G3	Ash, Elder, Horse Chestnut, Hawthorn, Goat Willow, Elm, Sycamore, Oak.	6-16	Mature	<b>Good</b> Linear group running up to the entrance to the Osier beds and the timber steps and bridges. Recent felling and clearance work carried out (2015).	Crown lift to 4m over footway and 2m back from the footway edge.	Low
G4	Ash, Elder, Horse Chestnut, Hazel, Goat Willow, Sycamore.	16	Mature	<b>Good</b> Linear group that follows the northern boundaries of the remnant Osier beds, and runs down to the Tanhouse Lane entrance. In places the group is only a metre or so wide, with the footway immediately adjacent.	Crown lift to 4m over the footway and 25m back from the footway edge.  Clear base of trees more than 300mm diameter at 1.5m height and inform Arboriculturalist once clear to allow survey to be carried out.	Low  Moderate
G5	Group of 3 distinct Osier stands.	6	Mature	<b>Good</b> Three distinct remnant groups. Possibility of re coppicing these trees to promote and conserve the stands. Clearance, crown lifting, and coppicing work recently carried out (2015). Still significant amount of Ivy growing on stems.	Crown lift to 4m over the footway and 2m back from the footway edge.	Low

No	Species	Height (m)	Age class	Condition (Physiological and structural)		Recommendations	Priority for works
G6	Beech, Copper Beech, Wild Cherry, Horse Chestnut, Hazel, Yew.	10	Mature	<b>Good</b>	Distinct small copse with footway boundaries to north and southwest. Generally very good condition, but might warrant a canopy thinning exercise to promote well spaced and structured canopy development. Hazel could be coppiced on a regular cycle.	Crown lift to 4m over the footway and 2m back from the footway edge.  Clear lamps by 2m.  Forestry thin by 20%.	Low  Low  Low
G7	Ash, Beech, Copper Beech, Silver Birch, Elder, Field Maple, Hawthorn, Hazel, Lime, English Oak, Wayfaring Tree.	10	Mature	<b>Good</b>	Distinct small copse with footway boundary to south. Well-used informal track around the north of the copse. Generally very good condition, but might warrant a canopy thinning exercise to promote well spaced and structured canopy development. Hazel could be coppiced on a regular cycle.	Crown lift to 4m over the footway and 2m back from the footway edge.  Clear lamps by 2m.  Forestry thin by 20%.	Low  Low  Low
G8	Dogwood, Hawthorn, Hazel, Holly, Lime, Whitebeam	6	Mature	<b>Good</b>	Linear group running along the eastern boundary of the site. Private gardens to the east and footway to the west. Dogwood starting to encroach over footway.	Crown lift to 4m over the footway and 1m back from the footway edge.  Dogwood and Hazel to be coppiced on an annual cycle to re-introduce a graded western edge to the group.	Low  Low
G9	Aspen, Dogwood, Hawthorn, Hazel, Goat Willow.	8	Mature	<b>Good</b>	Linear group running along the eastern boundary of the site. Private gardens to the east and footway to the west. Dogwood starting to encroach over footway.	Crown lift to 4m over the footway and 1m back from the footway edge.  Dogwood and Hazel to be coppiced on an annual cycle to re-introduce a graded western edge to the group.	Low  Low
G10	Hazel, Whitebeam, Buckthorn, Maple	-	Mature	<b>Good</b>	Encroaching on footway.	Clear footway by 3m.  Crown lift to 3m over footway.	Low  Low

Resurvey to be complete by 30<sup>th</sup> December 2017



**General notes:**

The tree survey has been carried out in relation to the landowner's duty under the Occupier's Liability Act 1984 and common law. The tree survey was carried out from ground level, identifying significant tree features that may have significant bearing upon the condition and management of the tree and giving appropriate recommendations and priorities. All dimensions are estimated. No soil investigations will be carried out.

To carry out the tree survey reasonable access around the base of the tree is required. Where this is not feasible, these parts of the tree may not be able to be inspected. If view of the entire structure of the tree(s) is limited, for instance by the properties in private ownership, this is a limitation to the tree survey and some parts of the tree may not be able to be fully surveyed. The tree survey will be carried out from the ground with the aid of binoculars if necessary. The tree will not be climbed as part of this survey.

Typical significant defects that are to be identified can be referred to in "Hazards from Trees, a general guide" by David Lonsdale and "The body language of trees" by Claus Mattheck published by the Forestry Commission and the Department of the Environment respectively.

The tree survey can only be an assessment of the tree at the time of the survey and the tree(s) should be re-surveyed on a regular basis. An appropriate time period between surveys may be up to 5 years depending upon the condition of the trees, their maturity and the target(s). Recommendations for the period between surveys will be given.

As trees are dynamic structures their condition and health may change in a short period of time, particularly in relation to changes in their immediate environment and circumstances. Therefore the survey is an assessment of the trees at the time of the survey only. If there is a significant change in the immediate environment and circumstances then this should be brought to the attention of the arboriculturalist so that they may advise accordingly.

I have not checked whether the site is within a Conservation Area or whether the trees are under Tree Preservation Order (TPO). Prior to any tree works confirmation of whether these legal restrictions apply to the site or trees ought to be sought from the Local Planning Authority (LPA). If the trees stand within a Conservation Area designated under the Town and Country Planning Act the LPA will normally require 6 weeks notice of intention to carry out any tree works as detailed in the survey. If the trees are under TPO then the LPA will normally require an application for any tree works. Some tree works are exempt, for instance if the trees are dead or dangerous, and certain works can be carried out without application. It is necessary to give the LPA at least five days notice prior to carrying out any of these tree works under these exemptions. This survey, with recommendations, can be used to support any such application or notice.

Wildlife issues are of significant concern to the general public. A balance has to be found between the protection of wildlife and the need for safety when managing trees. The Wildlife and Countryside Act (1980) and Countryside Rights of Way Act (2000) give statutory protection to wild birds, bats, mammals, some invertebrates and plants. It is important to ensure that this legislation is properly considered when carrying out any works to trees.

Bird nests were not identified whilst on site. However, any Arborist carrying out the tree works should ensure that there is no disturbance to nesting birds prior to the works being carried out. Further guidance upon the appropriate timing of the works can be sought from DEFRA, if necessary. Where nesting birds are found further information should be sought from DEFRA 08459 33 55 77 or [helpline@defra.gsi.gov.uk](mailto:helpline@defra.gsi.gov.uk).

In this instance, considering the size of the trees, their location and features I believe that there is a Moderate potential of bats using the mature trees as a roost site. A bat survey prior to tree works is not recommended as it would be difficult to determine the location of any exit point from the roost within the tree by a bat survey and also confusion may also arise from bats travelling from other roosts. Any such exit could more easily be identified by a competent tree worker. During the tree works the contractor should carry out the tree works with bats as an active consideration and follow the current industry best practice, e.g. Arboricultural Association Guidance Note 1 Bats in the context of tree work operations 2011, which a competent tree contractor should be familiar with.

Typical significant defects that are to be identified can be referred to in "Hazards from Trees, a general guide", "Principles of tree hazard assessment and management" both by David Lonsdale and "The body language of trees" by Claus Mattheck published by the Forestry Commission and the Department of the Environment respectively.

Trees are dynamic structures and as such their condition and health may change in a short period of time, particularly in relation to changes in their immediate environment and circumstances, as such the survey relates to the visible condition found on the day of the survey.

## Key to condition survey sheet

<b>No</b>	Tree number.								
<b>Species</b>	Species of tree.								
<b>Height</b>	Height measured in metres.								
<b>Branch Spread</b>	Branch spread in metres taken at the four cardinal points to derive an accurate representation of the crown.								
<b>Height of crown</b>	Height in metres of crown clearance above adjacent ground level.								
<b>Age Class (Age)</b>	<p><b>Young</b> A tree considered to be less than approximately 20 years old.</p> <p><b>Middle aged</b> A tree in approximately the first 1/5th of its normal life span with apical dominance (rapidly growing with a clear main leader) and not yet fully at its environmental potential full height.</p> <p><b>Mature</b> A tree in its 2/5ths to 5/5ths of its normal life span with apical dominance lost and at its environmental potential full height.</p> <p><b>Over mature</b> A tree beyond the normal life span for the location with apical dominance lost and with symptoms of canopy decline.</p> <p><b>Veteran</b> A tree of interest biologically, aesthetically or culturally because of its age and is old relative to others of the same species.</p>								
<b>Condition</b> (Physiological and Structural)	<p><b>Good</b> Full healthy canopy; but possibly including some suppressed branches or minor physical damage. A tree that requires little or no tree works and it is anticipated to be retained for over 20 years.</p> <p><b>Fair</b> Slightly reduced leaf cover, minor dead wood, or isolated major deadwood. A tree that requires tree works to remove defects and/or improve the form so that it may be anticipated to be retained for over 5 years.</p> <p><b>Poor</b> Overall sparse leafing or extensive dead wood. A tree that has a significant proportion of defects and/or requires considerable tree works to aid its retention and/or where the retention of the tree is not anticipated beyond 5 years.</p> <p><b>Very poor</b> Large areas of crown dead. A tree that has a significant proportion of defects and/or requires considerable tree works to aid its retention.</p>								
<b>Recommendations</b>	As per BS3998: 2010 Recommendations for Tree Works.								
<b>Priority</b>	<table border="0"> <tr> <td style="background-color: red; color: white; padding: 5px;"><b>Immediate</b></td> <td>Works should be carried out immediately as the probability of harm or damage occurring is likely.</td> </tr> <tr> <td style="background-color: red; color: white; padding: 5px;"><b>High</b></td> <td>These works are important to carry out as soon as reasonably possible and any budget available for tree management should be spent upon these trees before the moderate and low categories. Works in this category usually will relate to abatement of risk for harm and or damage to occur. Ideally works in this category are anticipated to be carried out within 1 month.</td> </tr> <tr> <td style="background-color: orange; padding: 5px;"><b>Moderate</b></td> <td>These works are important to carry out as soon as reasonably possible and any budget available for tree management should be spent upon these trees before the low categories. Works in this category usually will relate to abatement of risk for harm and or damage to occur and for the good arboricultural management of the trees. Ideally works in this category are anticipated to be carried out within 3 months.</td> </tr> <tr> <td style="background-color: yellow; padding: 5px;"><b>Low</b></td> <td>Works in this category usually will relate to the good arboricultural management of the trees. Ideally works in this category are anticipated to be carried out within 12 months.</td> </tr> </table>	<b>Immediate</b>	Works should be carried out immediately as the probability of harm or damage occurring is likely.	<b>High</b>	These works are important to carry out as soon as reasonably possible and any budget available for tree management should be spent upon these trees before the moderate and low categories. Works in this category usually will relate to abatement of risk for harm and or damage to occur. Ideally works in this category are anticipated to be carried out within 1 month.	<b>Moderate</b>	These works are important to carry out as soon as reasonably possible and any budget available for tree management should be spent upon these trees before the low categories. Works in this category usually will relate to abatement of risk for harm and or damage to occur and for the good arboricultural management of the trees. Ideally works in this category are anticipated to be carried out within 3 months.	<b>Low</b>	Works in this category usually will relate to the good arboricultural management of the trees. Ideally works in this category are anticipated to be carried out within 12 months.
<b>Immediate</b>	Works should be carried out immediately as the probability of harm or damage occurring is likely.								
<b>High</b>	These works are important to carry out as soon as reasonably possible and any budget available for tree management should be spent upon these trees before the moderate and low categories. Works in this category usually will relate to abatement of risk for harm and or damage to occur. Ideally works in this category are anticipated to be carried out within 1 month.								
<b>Moderate</b>	These works are important to carry out as soon as reasonably possible and any budget available for tree management should be spent upon these trees before the low categories. Works in this category usually will relate to abatement of risk for harm and or damage to occur and for the good arboricultural management of the trees. Ideally works in this category are anticipated to be carried out within 3 months.								
<b>Low</b>	Works in this category usually will relate to the good arboricultural management of the trees. Ideally works in this category are anticipated to be carried out within 12 months.								
<b>Re-survey</b>	This is the time period in which it is recommended that the tree is surveyed again. This is based upon the condition of the tree, its location, previous, current and future management. It is normally expressed at a time period from the date of the report / survey, which ever is the sooner. If no time period is noted then the default period is one year.								

## Site plan

**General / Key:**

- Tree position ●
- Tree position (removed) ○
- Group position 



**Client:**  
Alton Town Council

**Site:**  
Flood Meadows, Alton

**Data:**  
provided under license 100019980.  
Crown copyright. All rights reserved.

This drawing is copyright of Sapling Arboriculture Limited and may not be copied, altered or reproduced in any way without written authority from Sapling Arboriculture Limited.

**Drawing title:**  
Tree condition survey - overview

**Drawing reference:**  
J064 / 14 / 2016

**Revision:** -

**Date:**  
November 2016

**Scale:**  
N/A on A4 - do not scale

**Sheet:**  
1 of 3

**sapling**  
arboriculture ltd

registered in england: 5414238

T: 01420 544 860  
E: ben@saplingarboriculture.com  
W: www.saplingarboriculture.com

**Ben Abbott**  
MICFor, MRICS, CEnv, Dip. Arb. (RFS), BA (Hons)  
Arboricultural Association Registered Consultant

**Note:** tree positions are indicative only  
due to the access to the trees being  
limited.



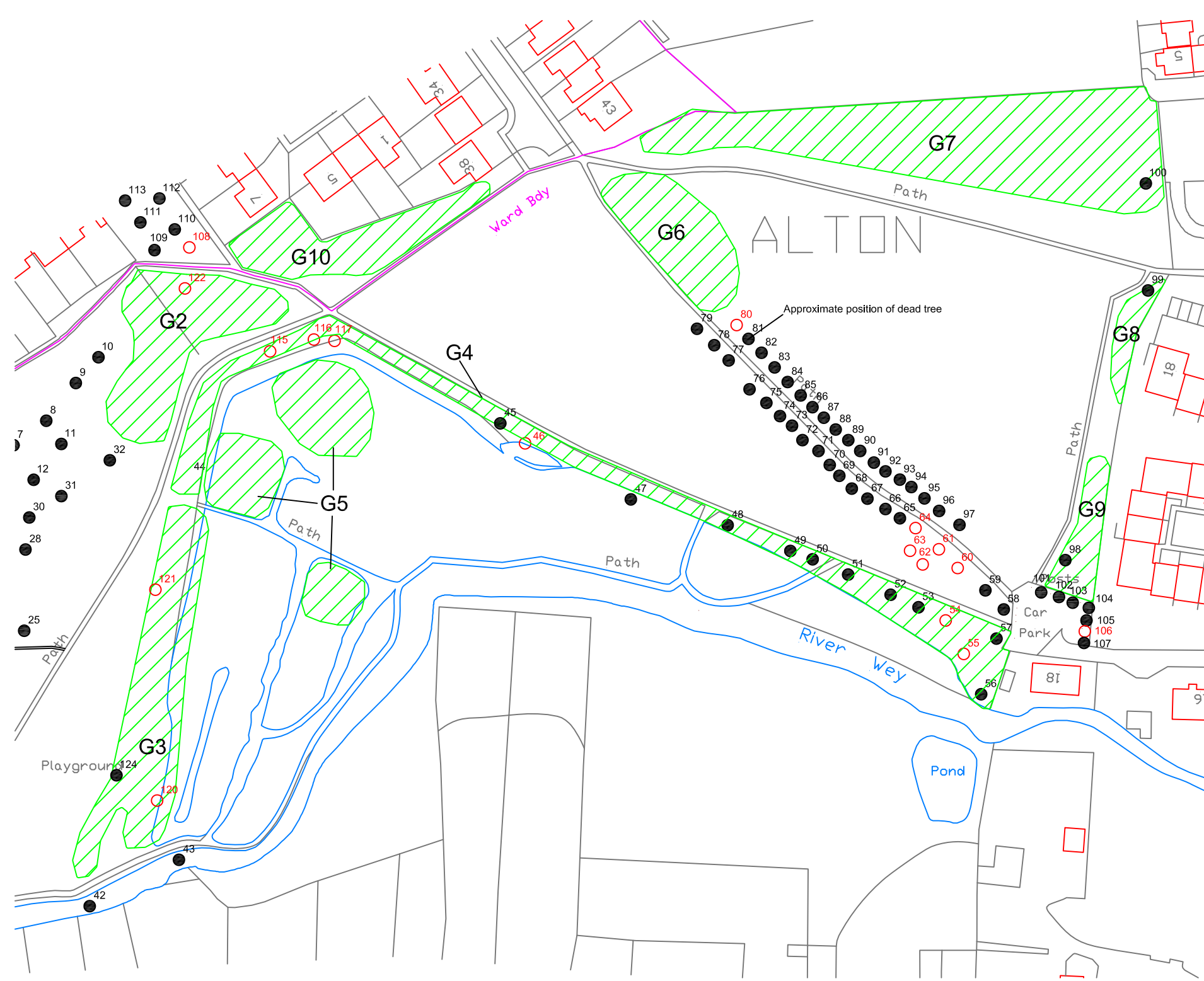

**General / Key:**

- Tree position ●
- Tree position (removed) ○
- Group position [Green hatched area]

**Client:** Alton Town Council  
**Site:** Flood Meadows, Alton  
**Data:** provided under license 100019980. Crown copyright. All rights reserved.  
This drawing is copyright of Sapling Arboriculture Limited and may not be copied, altered or reproduced in any way without written authority from Sapling Arboriculture Limited.

**Drawing title:** Tree condition survey  
**Drawing reference:** J064 / 14 / 2016  
**Revision:** -  
**Date:** November 2016  
**Scale:** N/A on A4 - do not scale  
**Sheet:** 2 of 3

**sapling arboriculture ltd**  
 registered in england: 5414238  
 T: 01420 544 860  
 E: ben@saplingarboriculture.com  
 W: www.saplingarboriculture.com

**Ben Abbatt**  
 MCFar, MRICS, CEnv, Dip. Arb. (RFS), BA (Hons)  
 Arboricultural Association Registered Consultant

**Note:** tree positions are indicative only due to the access to the trees being limited.

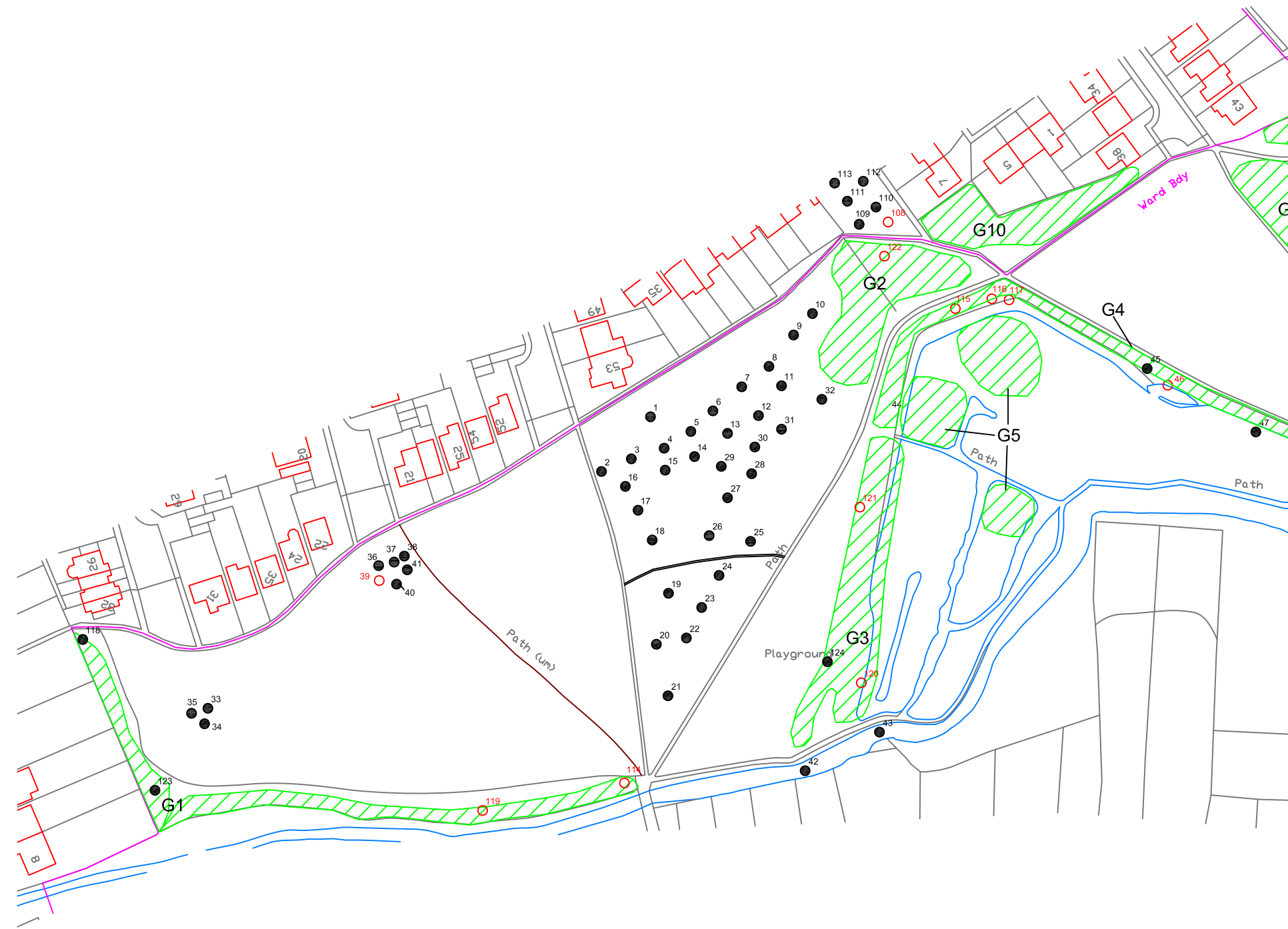

**General / Key:**

- Tree position ●
- Tree position (removed) ○
- Group position



---

**Client:**  
Alton Town Council

**Site:**  
Flood Meadows, Alton

**Data:**  
provided under license 100019980.  
Crown copyright. All rights reserved.

This drawing is copyright of Sapling Arboriculture Limited and may not be copied, altered or reproduced in any way without written authority from Sapling Arboriculture Limited.

---

**Drawing title:**  
Tree condition survey

**Drawing reference:**  
J064 / 14 / 2016

**Revision:** -

**Date:**  
November 2016

**Scale:**  
N/A on A4 - do not scale

**Sheet:**  
3 of 3

---

sapling

arboriculture ltd

registered in england: 5414235

T: 01420 544 860  
E: ben@saplingarboriculture.com  
W: www.saplingarboriculture.com

**Ben Abbott**  
MCFor, MRICS, CEnv, Dip. Arb. (RFS), BA (Hons)  
Arboricultural Association Registered Consultant

---

Note: tree positions are indicative only due to the access to the trees being limited.



## CONDITIONS OF ENGAGEMENT

### 1. Interpretation

'Client' means the person named on the Quotation for whom the Contractor has agreed to provide Specified Services in accordance with these terms.

'Contract' means the Contract for the provision of the Specified Services.

'Contractor' means Sapling Arboriculture Ltd.

'Quotation' means the Quotation to which these Terms and Conditions apply.

'Specified Services' means the service to be provided by the Contractor to the Client, as referred to in the Quotation.

### 2. The responsibilities of the Contractor

2.1 The Contractor shall provide the Specified Services to the Client as set out in the Quotation.

2.2 Timescales for the Specified Services will be agreed with the Client and adhered to as far as is reasonable. Where information received is out of date, inaccurate or if scheme design changes, it may not be possible to adhere to agreed timescale.

2.3 The Contractor shall provide his opinion on those matters in respect of which he has given the Client express written confirmation and subject to the limitations and conditions stated. The Contractor will not purport to express an opinion about or advise upon the condition of un-inspected parts of the land or trees and should not be taken as making any implied representation or statements about such parts.

2.4 The Contractor will only provide advice on matters within his arboricultural experience and qualifications.

### 3. The responsibilities of the Client

3.1 The Client shall provide the Contractor with accurate and up to date information as requested by the Contractor in a timely manner and in the format requested.

3.2 The Client shall notify the Contractor in writing of any changes to the Specified Services brief in the Quotation, scheme design or works instructions.

3.3 If a report suggests further investigation works be carried out by a specialist firm or person (e.g. Structural Engineer, Surveyor) the Client is responsible for sourcing such services and information. On no account will liability be accepted by the Contractor in respect of such matters nor if the client proceeds or acts without obtaining and acting upon the relevant further advice.

### 4. Assumptions

4.1 That the land, which is the subject of the inspection or survey, is not subject to any unusual or especially onerous restrictions, encumbrances or outgoings and that good title can be shown;

4.2 That the land and its value are unaffected by any matters which might be revealed by a local land search or replies to conveyancing enquiries or by any statutory notice and that neither the land nor its condition nor its uses nor its intended uses is, or will be unlawful or contrary to planning or building regulations;

4.3 That inspection of those parts of the land or soil strata or any tree which have not been inspected would neither reveal material defects nor cause the Contractor to alter his opinion materially;

4.4 That there are no underground pipes, wires, cables or others services or installations which might be damaged as a result of work recommended or necessary; and

4.5 That no tree is subject to legislation relating to Conservation Areas, Tree Preservation Order or terms of a planning consent, in relation to which the Client must make his own enquiries of the Local Planning Authority.

### 5. Charges

5.1 The Client shall pay the Contractor its fee regardless of any outcome as well as reimbursing the cost of all reasonable out of pocket expenses incurred.

5.2 Payment in full (including VAT) must be paid within 14 days of the date of the invoice.

5.3 No discount nor retention or set off against the amount due is allowed unless previously agreed by the Contractor in writing.

5.4 The Contractor reserves the right to charge interest on any monies which are not received within 14 days. In accordance with the Late Payment of Commercial Debts (Interest) Act 1998 the Contractor will be entitled to charge interest (both before and after any judgement of the amount unpaid) at the rate of 10% per month over the Bank of England base rate until payment in full is made (part of the month shall be treated as a full month for the purpose of charging interest).

5.5 All unpaid accounts will be referred to the County Courts. Sapling Arboriculture Ltd reserves the right to claim compensation in respect of debt recovery costs.

5.6 Sapling Arboriculture Ltd reserves the right to withhold the release of reports and other Specified Services until payment is received in full.

#### **6. Contractor liability**

- 6.1 Any report is provided for the sole use of the named client and is confidential to the client and his professional advisors. The Contractor accepts responsibility to the Client alone for the stated purposes of the report, which will be prepared with the skill, care and diligence reasonably expected of a competent Arboricultural Consultant, but no responsibility whatsoever is accepted to any person other than the client himself. Any other such person relying on the report does so at his own risk. Neither the whole nor any part of the report or any reference thereto may be included in any published document, circular or statement nor may it be published in any way without the Contractor's prior written approval of the form and context in which it may appear. Liability is limited to the amount that the Contractor is insured to. Intellectual Property Rights shall remain in the ownership of the Contractor.
- 6.2 The Contractor shall not be held liable to the Client or deemed to be in breach of the Contract by reason of any delay in performing, or failing to perform any of the Contractor's obligations in respect of the Specified Services, if the delay or failure was beyond the Contractor's control.
- 6.3
- (i) Subject as expressly provided in these conditions, and except where the client is sold to a person dealing as a consumer (within the meaning of the Unfair Contract Terms Act 1977) all warranties, conditions or other terms implied by the statute or common law are excluded to the fullest extent permitted by law.
  - (ii) Any claim by which the client is based on any defect in the nature or quality of the Company's services shall be notified to the Company within 7 days from the date of supply.
  - (iii) Except in respect of death or personal injury caused by the Company's negligence, the Company shall not be liable to the client by reason of any representation, or implied warranty, condition or other term, or any duty at common law, or under the express terms of any contract, for any consequential loss or damage (and whether caused by the negligence of the Company, his employees or agents or otherwise) which arise out of or in connection with the Contractor's services, except as expressly provided in these conditions.

#### **7. Miscellaneous**

- 7.1 Quotations are valid for 28 days from the date of the quotation.
- 7.2 Any dispute arising out of or in connection with the contract between the client and the Company shall be referred to the arbitration or a single arbitrator appointed by agreement between the parties or, in default of agreement, nominated on the application of either party to the Arboricultural Association.
- 7.3 The Contractor reserves the right to refuse work(s) if a conflict of interest is identified or arises.
- 7.4 The report is valid for a period of one year from the date on the report.
- 7.5 Each provision of these conditions limiting or excluding liability operates separately in itself and survives independently of the others.
- 7.6 The Contract between the Client and the Contractor shall be governed by the laws of England.